



Reading Technologies, Inc

"Your Source for Dry Air!"™

Toll Free 1-800-521-9200

www.rti-pbe.com

EH4000 Parts Breakdown

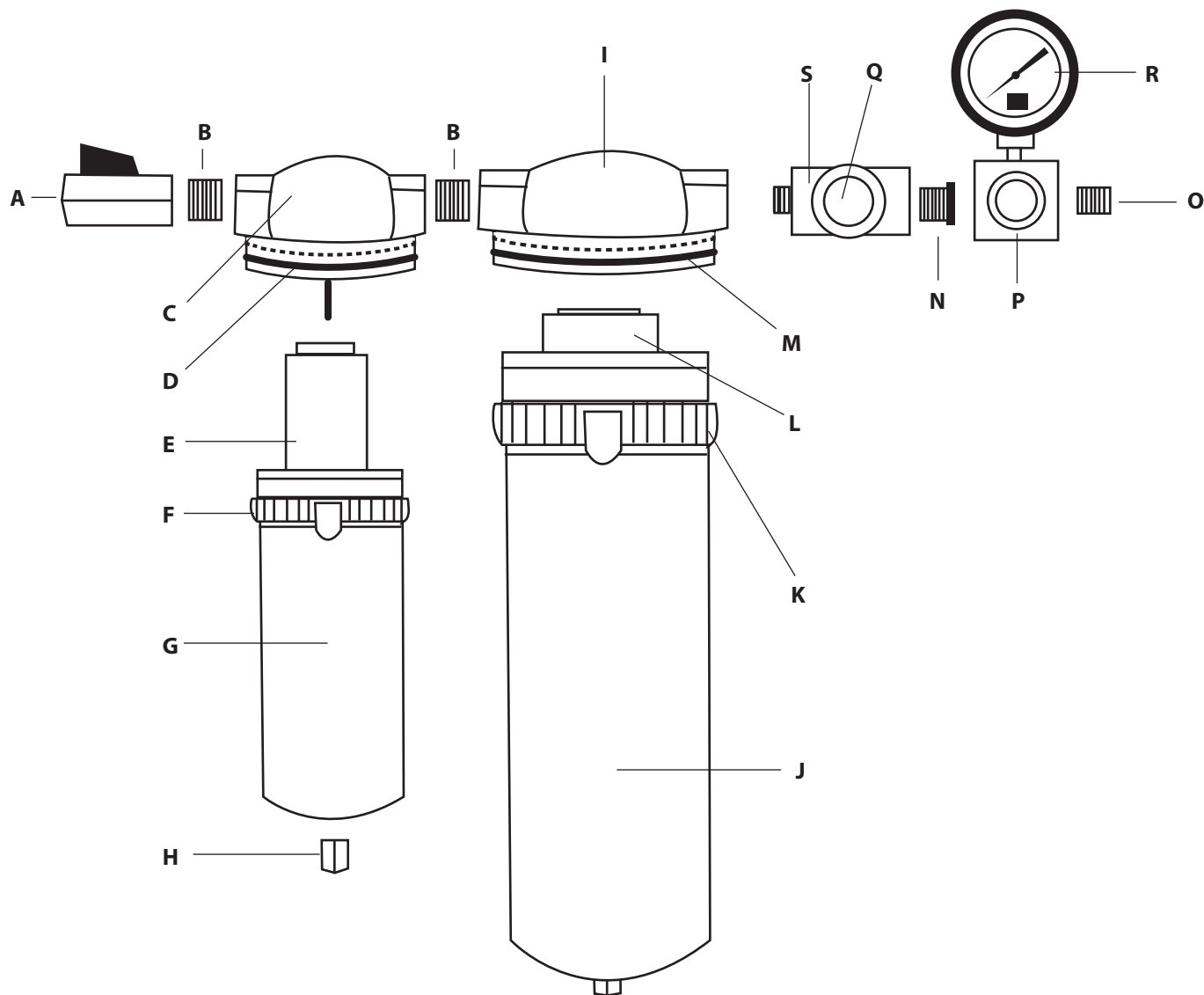

| Description | Part # | Description | Part # |
|---|------------|---------------------------------|------------|
| A 1/2" Ball Valve (Shut off) | BV-050 | K 2nd Stage Bowl Ring (only) | WIL-013 |
| B 1/2" Nipple | AB032-1/2 | L Desiccant Cartridge | DE-401 |
| C 1st Stage Head (NO Indicator) | WIL-040 | M 2nd Stage O-ring | N32-95-256 |
| C 1st Stage Head Assembly (w/Indicator) | WIL-059 | N 1/2" to 1/4" Reducer | MPF-004 |
| D 1st Stage O-ring | N32-97-257 | O 1/4" Nipple | MPF-001 |
| E 1st Stage Carbon Element | 4P-060 | P 1/4" Regulator | R79 |
| F 1st Stage Bowl Ring (only) | WIL-035 | Q Indicator Eye with Paper | RTi-SG-651 |
| G Bowl Assembly w/ Drain | N34-95-201 | R Pressure Gauge 160 PSI | PG-160 |
| H Auto Drain | N32-95-979 | S Indicator Assembly (Moisture) | RTi-04-CK |
| I 2nd Stage Head Assembly | WIL-001M | | |
| J 2nd Stage Bowl | N34-15-180 | | |